

## 91000-GL

15A Decorator Full Guide Light

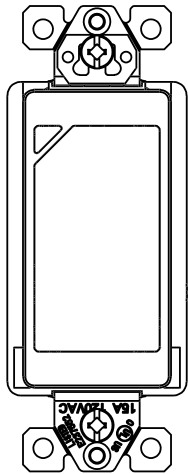

### WARNING

**Turn the POWER OFF at the circuit breaker before installing the switch.**

Read and understand these instructions before installing. This device is intended for installation in accordance with the National Electric Code and local regulations. It is recommended that a qualified electrician performs this installation. Make sure to turn off the circuit breaker or fuse(s) and make sure power is off before wiring the device.

Use copper wire only.

### WIRING DIRECTIONS

Turn off the power at the circuit breaker. Identify the HOT, NEUTRAL, and GROUND wires in the wall box. Insert wires into the terminal holes on the back side of the receptacle, then tighten the terminal screws to clamp wires in place.

- Insert the BLACK (LINE) wire into HOT terminal
- Insert both the WHITE wires into the NEUTRAL terminal (With silver screw)
- Clamp the two GREEN/BARE (COPPER) wires together, then insert one ground wire into the GR terminal (Green screw)

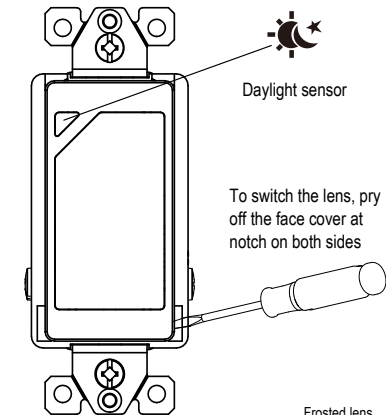

Daylight sensor

To switch the lens, pry off the face cover at notch on both sides

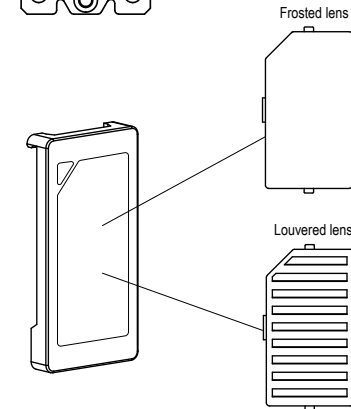

Frosted lens

Louvered lens

### SPECIFICATIONS

Rating.....	15 Amp, 125VAC
Wire Terminals.....	#14--#12 AWG
Operating Temperature.....	-4 to 140°F (-20 to 60°C)
Dimension .....	2-3/4"×1-1/2"×1-5/16"

### DESCRIPTION

The 91100-GL is a decorator with a built-in LED guide light. A daylight sensor automatically controls the guide light and turn on when a room becomes dark. It is ideal for hallways, kitchens, nurseries and more.

### FEATURES

- Full Guide light can replace any standard receptacle
- 2700K LED Guide Light with Daylight sensor
- Clamp-Type wire terminals are designed for easy installation from the back
- Lamp life rated 50,000 hours
- UL Listed

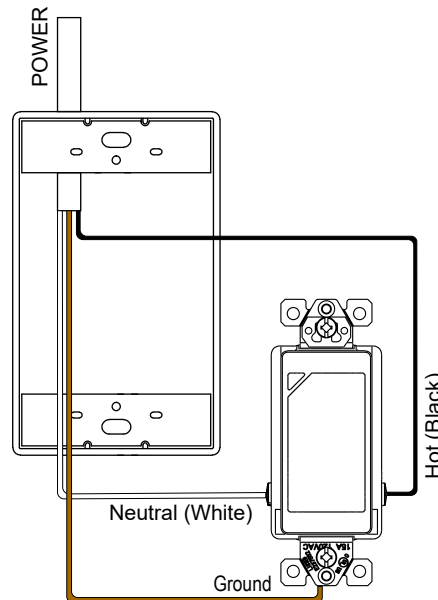

### WARRANTY INFORMATION

This device is warranted to be free of material and workmanship defects for 2 years from the date of purchase. Original receipt or proof of purchase from an authorized retailer must be presented upon warranty claim. ALL claims must be verified and approved by Enerlites, Inc. Warranties from other Enerlites products may vary. This warranty is nontransferable and does not cover normal wear and tear or any malfunction, failure, or defect resulting from misuse, abuse, neglect, alteration, modification, or improper installation. To the fullest extent permitted by the applicable state law, Enerlites shall not be liable to the purchaser or end user customer of Enerlites products for direct, indirect, incidental, or consequential damages even if Enerlites has been advised of the possibility of such damages. Enerlites' total liability under this or any other warranty, express or implied, is limited to repair, replacement or refund. Repair, replacement or refund are the sole and exclusive remedies for breach of warranty or any other legal theory.

